

BIPUMP



EN DC fuel transfer pumps

Displacement, self-priming, rotary electric vane pumps for transferring diesel fuel, characterized by high flow rates. All pumps are equipped with by-pass valve. Powerful, dependable and economical, they are available in 12 and 24-volt versions. Thanks to their compact size, ease of installation, dependability and safety, these pumps are used as the primary system on earth-moving machinery and on mobile fuel pumps on vehicles or in construction yards.

Technical specifications

- Cast iron pump body finished with anti-corrosion paint.
- Vane pump with sintered steel rotor and acetal resin vanes.
- By-pass valve incorporated in the pump body.
- Direct current brush motor with permanent magnet stator.
- Motor protection grade IP55.
- Used in intermittent service with 30-minute work cycles.
- Pump attachment support bracket.
- Integrated on/off resettable switch.
- Flanged 1" connectors.
- Available with power cables, and pincers for connection to terminal strips.

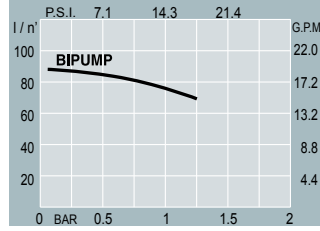

Kit handle



Bipump → BI-POWER

Flow rate up to **85 l/min**
12 or 24 V

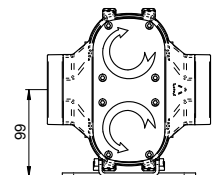
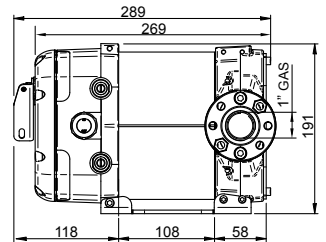
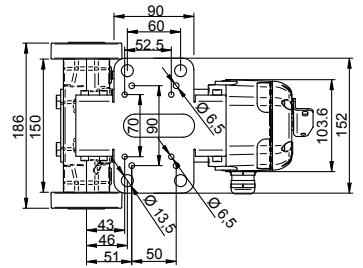

BIPUMP

Code	Description	On/Off	Flow rate		DC				I/O (*)	Weight Kg	Packaging mm	
			l/min	gal/min	V	Amp	Duty cycle min	rpm				
F00363A0A	Bipump 12V with on/off switch		•	85	22,4	12	42	30	2000	1" G	9,9	190x350x280
F00363B0A	Bipump 24V with on/off switch		•	85	22,4	24	21	30	2000	1" G	9,9	190x350x280
F0036301A	Bipump 12V with cable 2 m		•	85	22,4	12	42	30	2000	1" G	10,2	190x350x280
F0036302A	Bipump 12V with cable 4 m		•	85	22,4	12	42	30	2000	1" G	10,4	190x350x280
F0036303A	Bipump 24V with cable 2 m		•	85	22,4	24	21	30	2000	1" G	10,2	190x350x280
F0036304A	Bipump 24V with cable 4 m		•	85	22,4	24	21	30	2000	1" G	10,4	190x350x280
F0036321A	Bipump 12/24 without on/off switch			85	22,4	12/24	42/21	30/30	2000	1" G	8,5	190x350x280
F14334000	Kit cable 2 m										0,7	Blister
F14335000	Kit cable 4 m										0,7	Blister
F14200000	Kit handle										0,3	Blister

(*) Wide range on request